

Sliding Door

The sliding door provides excellent weather tightness together with enhanced thermal performance, complies with all of the requirements associated with this product type. Available in two different options, with regard to the level of thermal performance, the door is further categorised as “ST” and “HI,” standard or highly insulated. The design & arrangement of the system profiles enable luxurious openings of large dimensions, accommodating double & even triple glass unit compositions, which in conjunction with the constituent parts & innovative technical solutions, help achieve a high level of thermal & acoustic performance.

Design:	The slender and durable profile makes it possible to build a low-threshold door weighing up to 600 kg, with a height of up to 3.2 m and a width of up to 3.3 m. The frames are available in twin-track and triple-track variants.
Air permeability:	class 4, EN 12207
Water tightness:	class 9A, EN 12208
Wind load classification:	to class C4, EN 12210

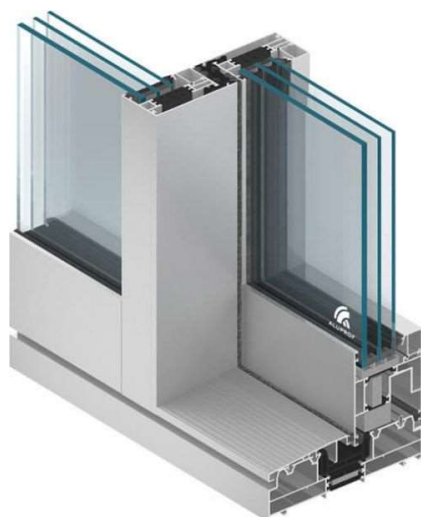



- 90° and 270° corners can be built, creating an exceptionally large space once the door is open
- a slender, 47 mm mullion
- convenient solutions featuring a low threshold
- a wide range of infills, including the use of single- or double-glazed units, as well as thermal breaks, a range of accessories and insulating inserts making it possible to achieve excellent thermal and acoustic parameters
- three styles of glazing beads: Standard, which is rectangular; Prestige, which is rounded; and Style, which is diamond shaped

Standard parameters of leaves for GU fittings

Leaf profile	K518808X K518809X	K518810X K518811X
Weight	max 200kg	max 300kg (400kg*)
Length Ls	700-2200mm	720-3300mm
Heigh Hs	1841-2741mm	1843-2743mm

*- with additional carriages

Standard parameters of leaves for HAUTAU fittings

Leaf profile	K518808X K518809X		K518810X K518811X
Weight	max 120kg	max 200kg	max 330kg
Length Ls	650-2360mm	650-2360mm	755-3255mm
Heigh Hs	1291-2491mm	1291-2791mm	1307-2807mm

Recommended Hs: $Ls \leq 3: 1$

Technical specification

Frame depth	174mm (2-rail profile), 271mm (3-rail profile)
Casement depth	77mm
Glazing thickness	13,5-61mm
Minimum width of frame	48mm
Minimum width of sash	94.5 – 105.5 mm
Maximum dimensions	H _s =3,24m, L _s =3,3m
Thermal insulation	U _f from 1,4 W/m ² K, U _w from 0,84 W/m ² K*

* - U_w for MB-77HS HI doors with 3000x2900mm leaf and glazing of U_g=0,5 W/m²K equipped with a Chromatech Ultra spacer.

Avilable door construction

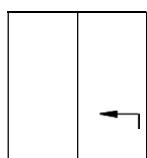

Scheme A

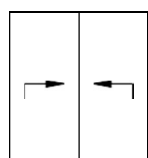

Scheme D

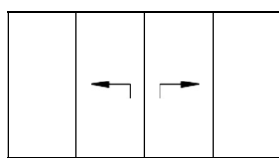

Scheme C

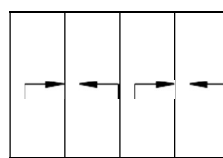

Scheme F

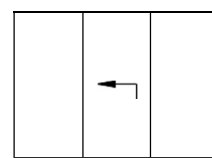

Scheme G2

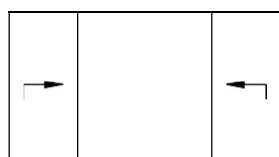

Scheme K

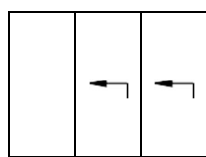

Scheme A+G

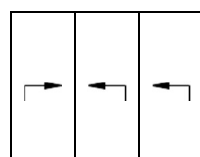

Scheme D+G

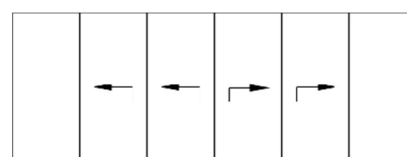

Scheme C+D+G

Solutions

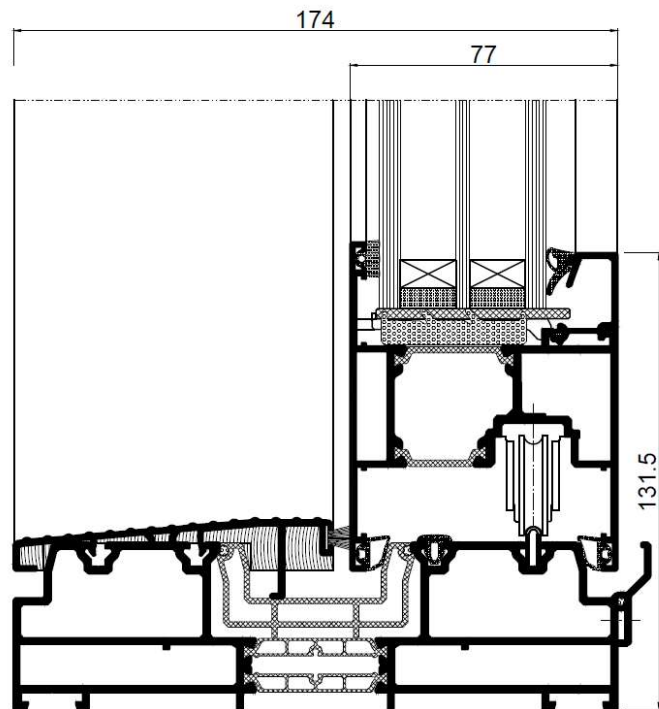

2-rail frame with regular bottom rail

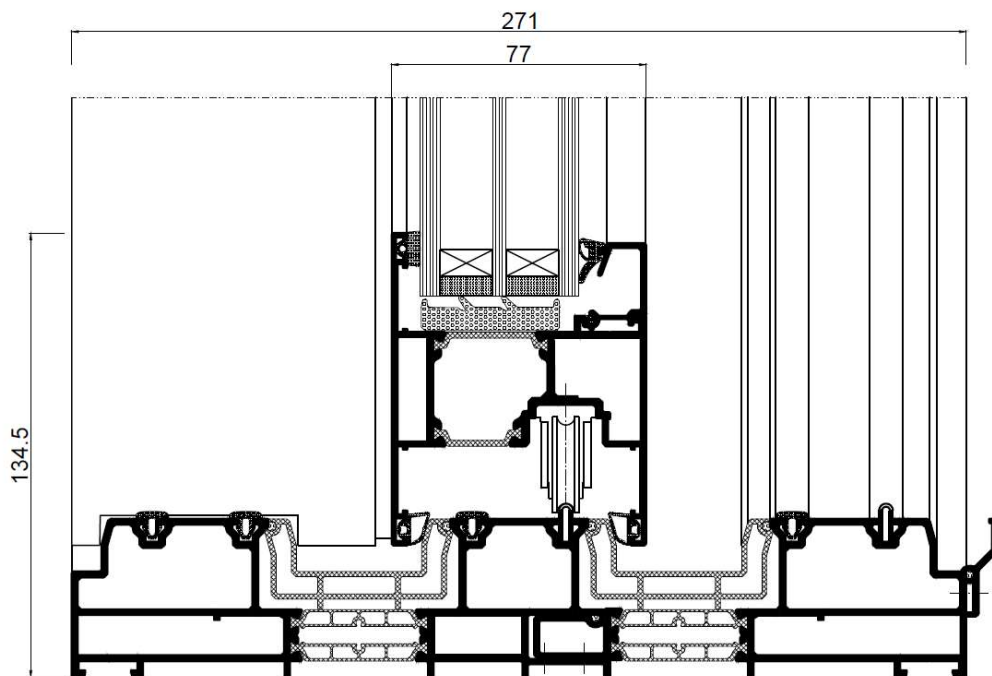

3-rail frame with regular bottom rail

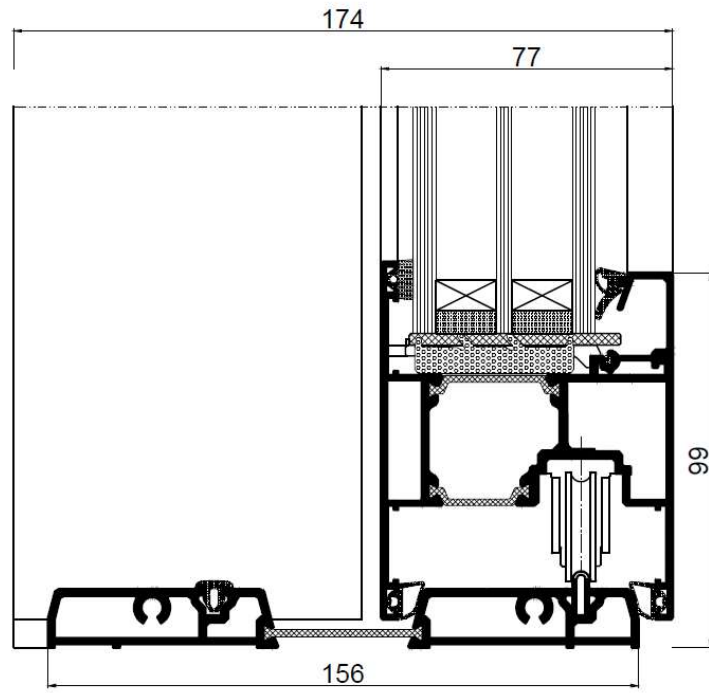

Flat bottom rail

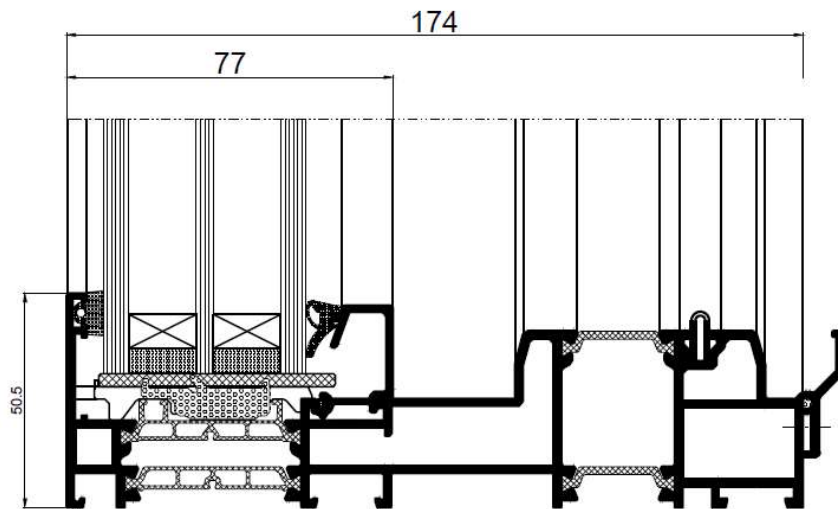

Fixed glazing in frame

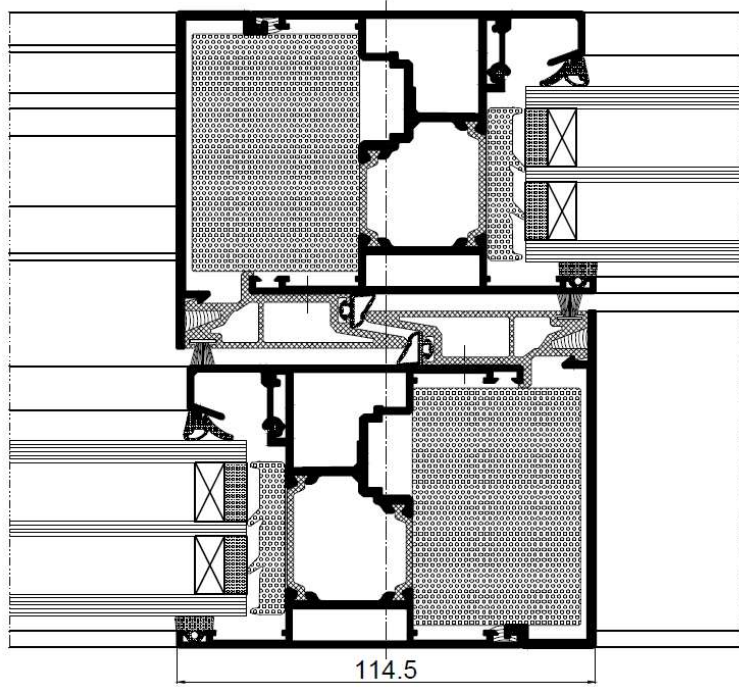

Regular mullion

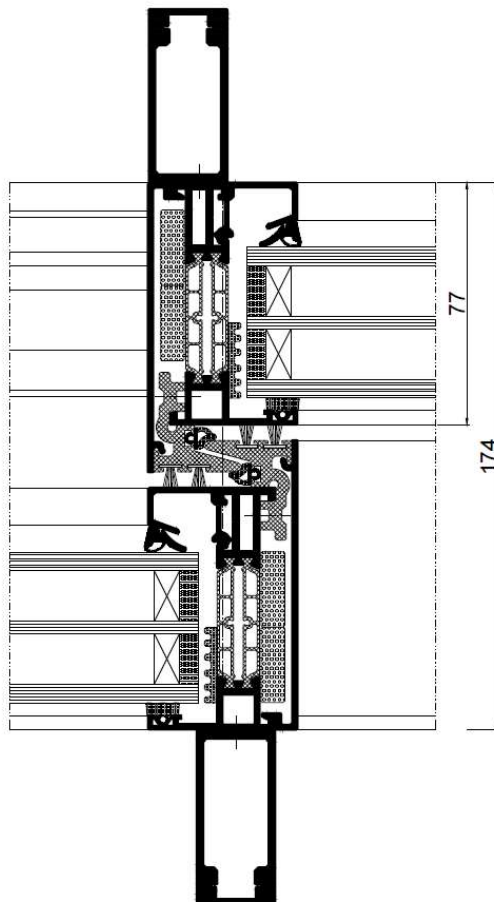

Slender mullion

Handles

ALUPROF CLASSIC

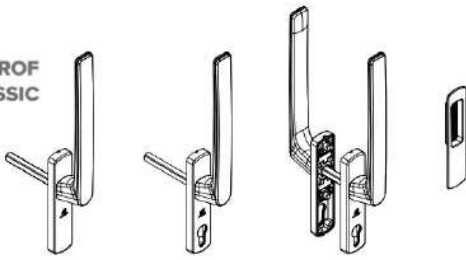

ALUPROF STANDARD

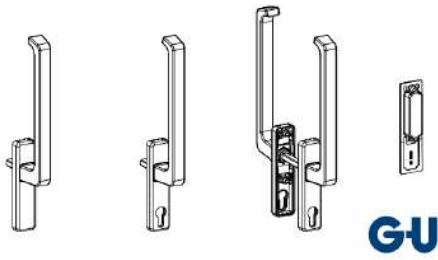
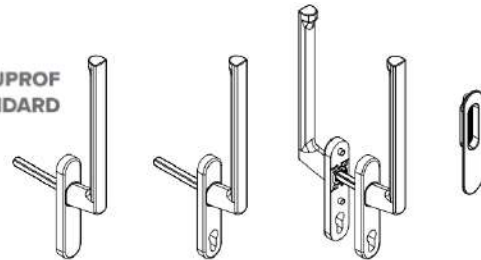

ALUPROF STYLE

